



picobricks.com



RobotistanINC
Selim GAYRETLI (Content) - Mehmet Suat MORKAN (Editor) - Atakan OZTURK (Engineer)
Elanur TOKALAK (Graphic Designer) - Dilara ULUSUN (Industrial Designer)

3 Germany Drive STE 4 #1430 Wilmington, DE 19804
hello@robotistan.com



Smart Home Pro Kit

Instruction Manual



Project Content

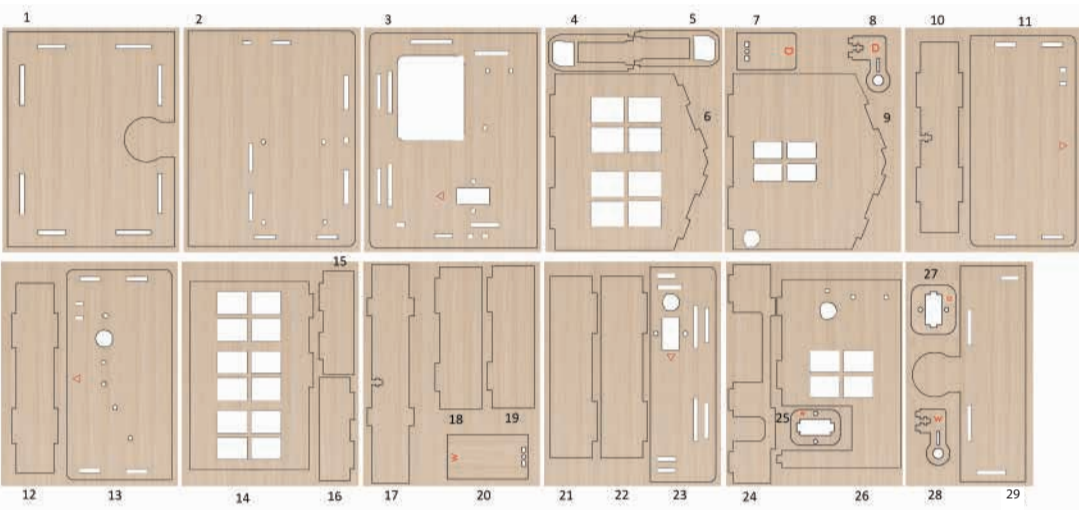

Project Content

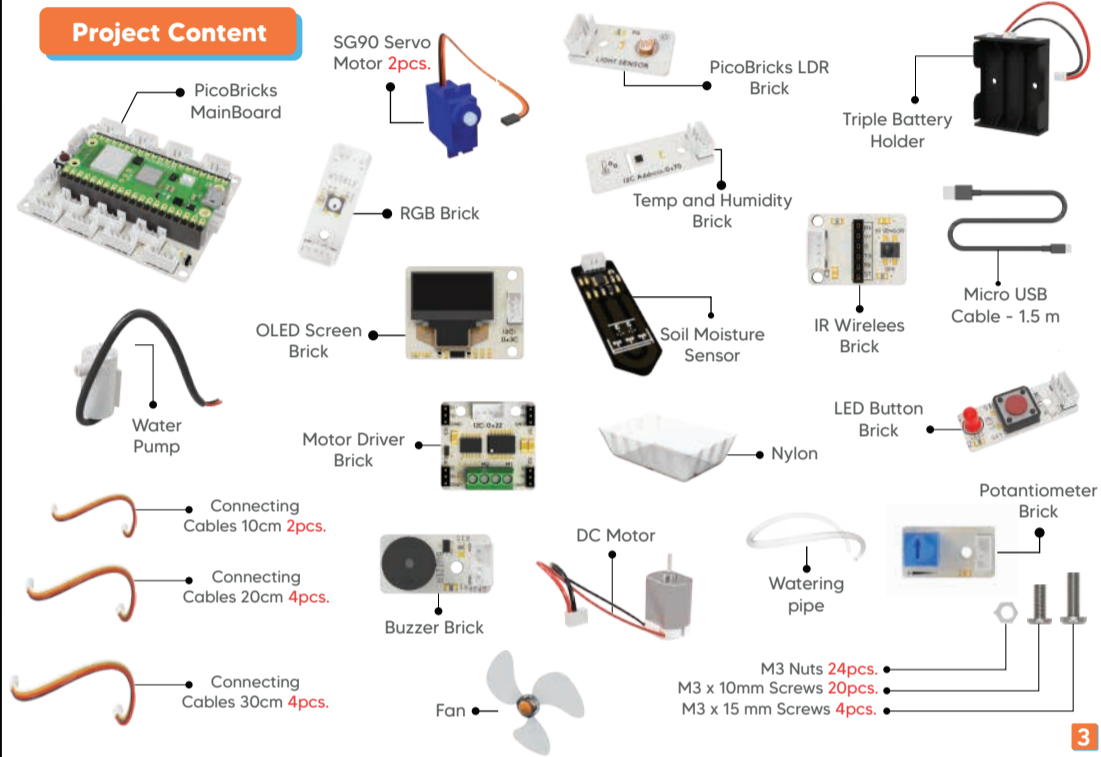

Servo Motor Calibration

Before starting the assembly, you have to manually calibrate the angles of the servo motors. Otherwise, Servo Motors won't be working properly.

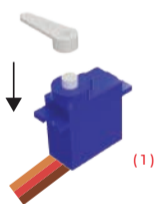

Attach the servo horn to the servo motor (1)

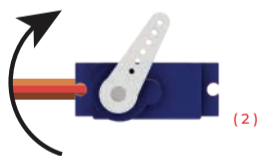

Then slowly turn the servo horn clockwise until it stops. It is not a problem if the servo horn is not the same as the angle shown in the image above. The important thing here is that you have hit the last angle of the servo. (2)

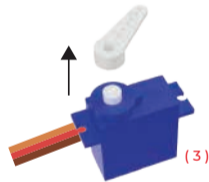

Remove the servo horn from the servo motor (3)

1

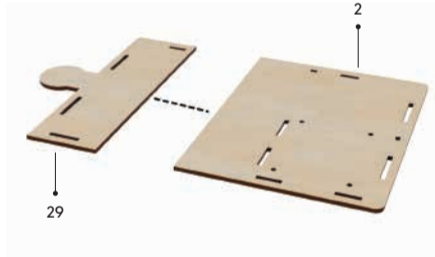

3

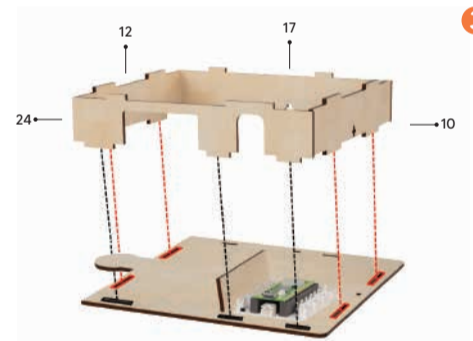

2

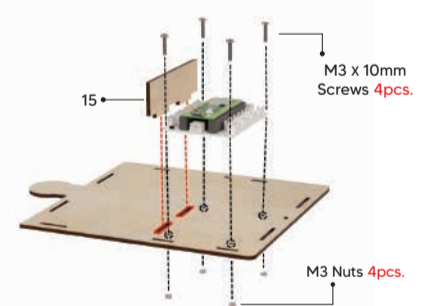

4

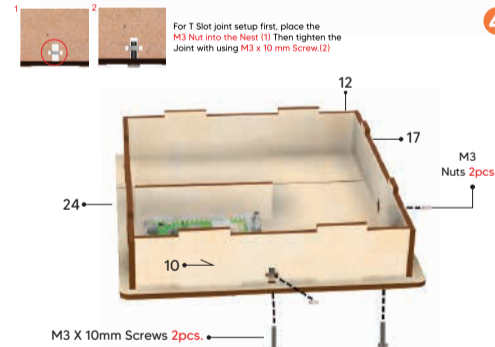

5

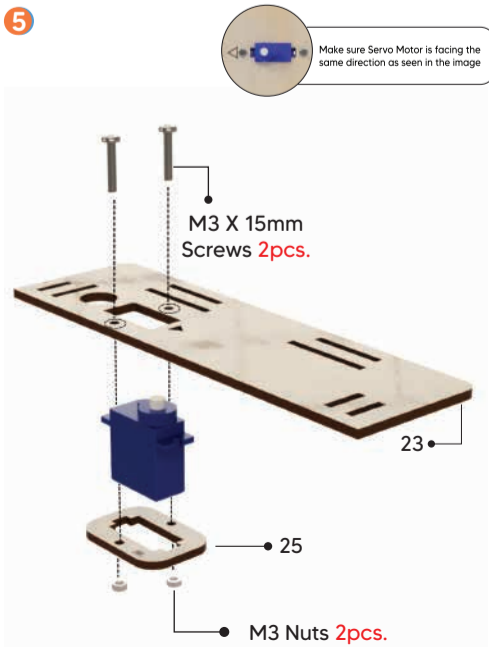

6

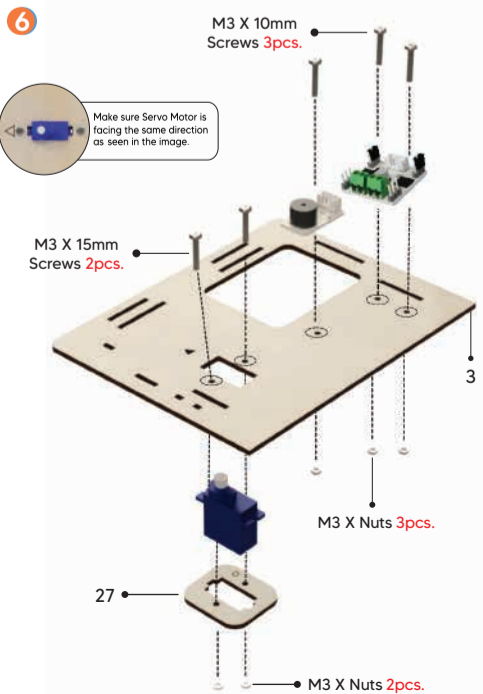

7

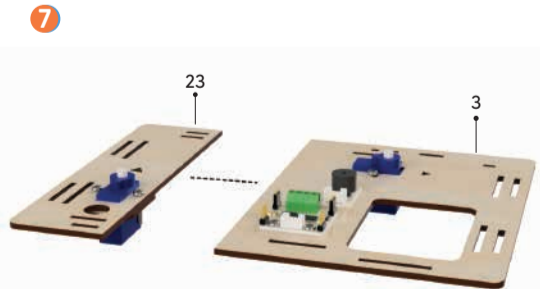

9

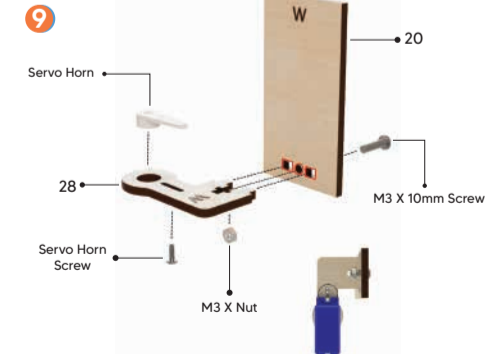

8

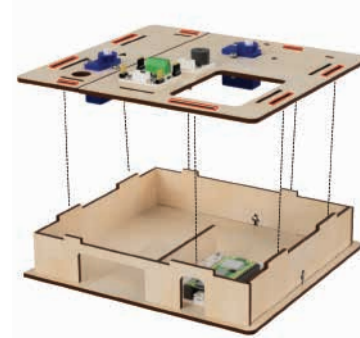

10

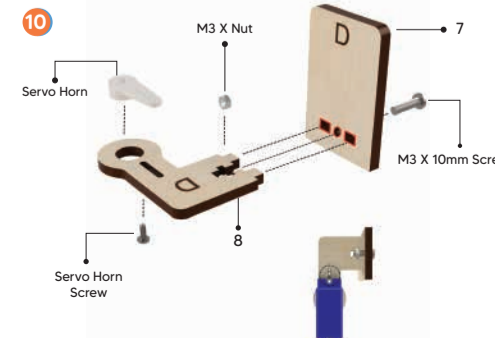

11

Servo Horn
Mounting Screws
2pcs.

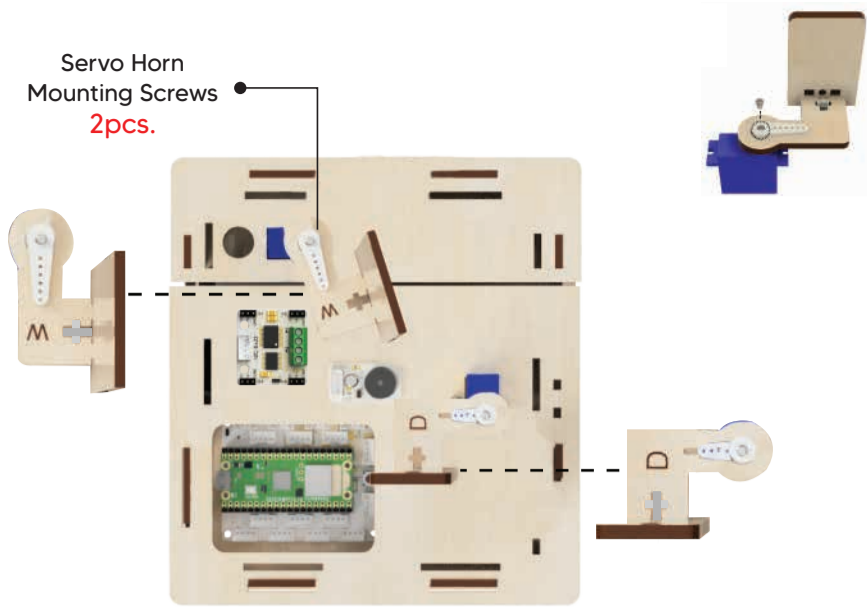

8

Setting Up The Circuit

Let's get to know the circuit elements of Smart Home that we completed the setup and make the circuit setup with PicoBricks bricks.

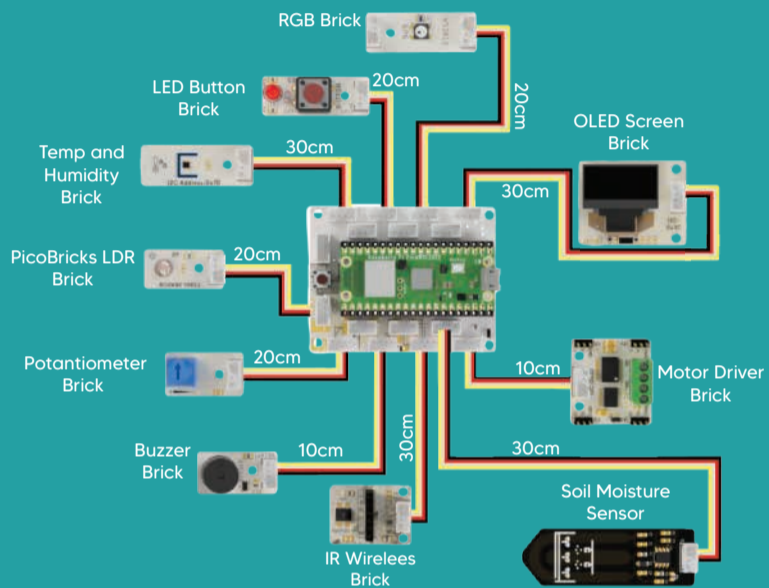

10

12

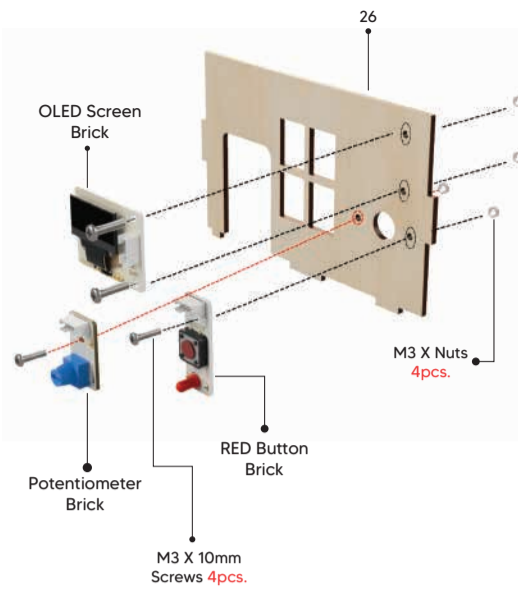

13

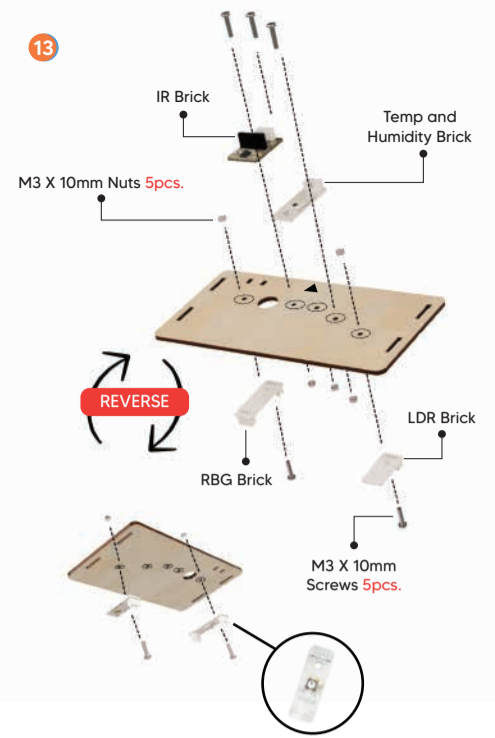

9

15

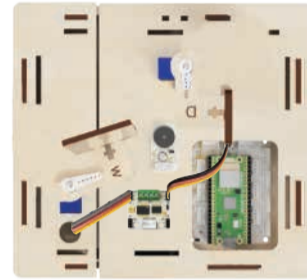

17

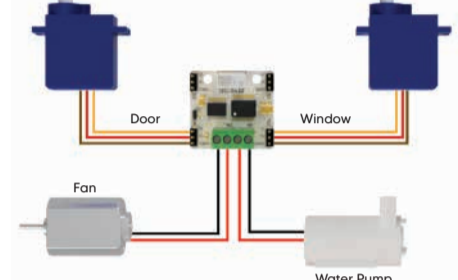

16

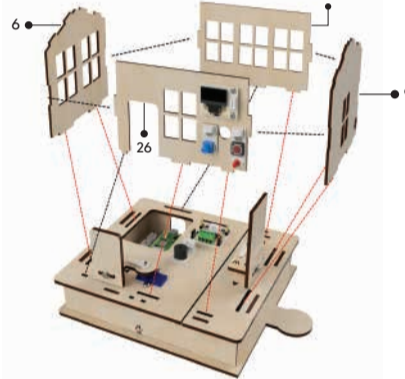

18

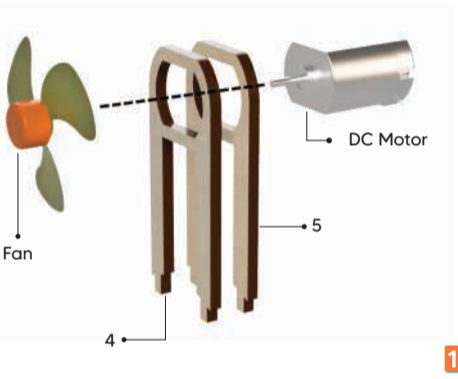

11

19

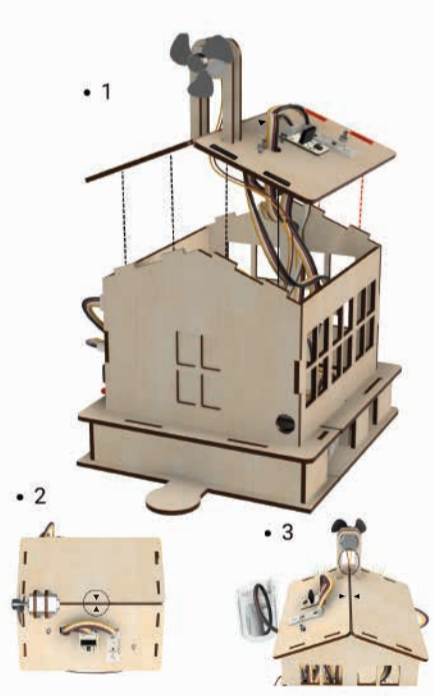

20

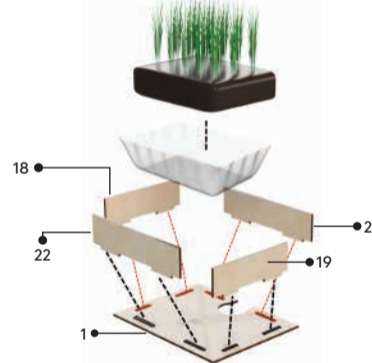

21

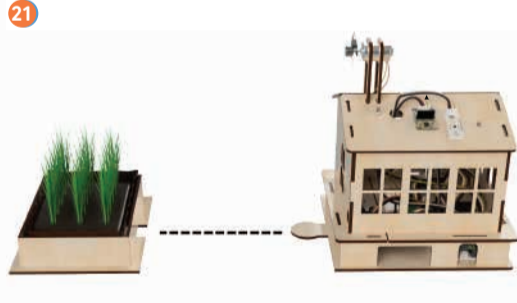

12

22

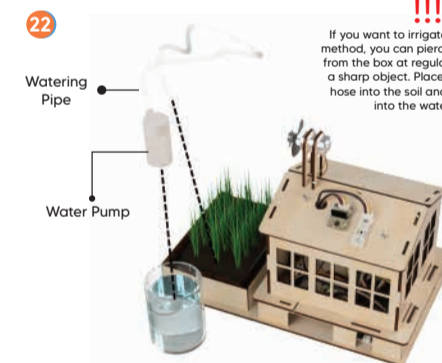

24

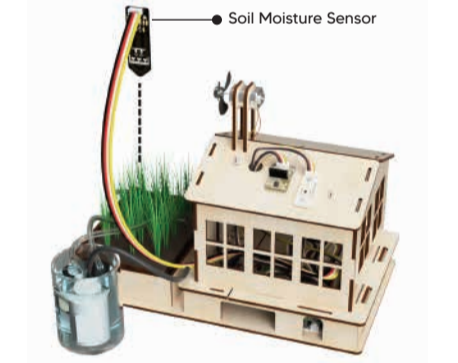

23

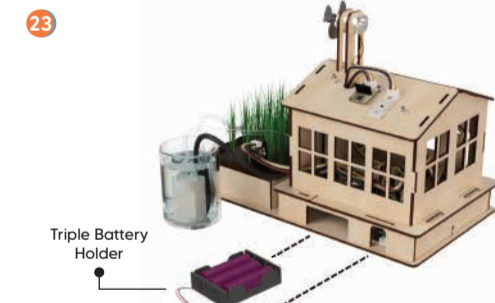

25



13



CHECKLIST

If PicoBricks Smart Home Pro Kit is not working properly after completing the installation, you can check the steps below.

- ☐ Are you sure that batteries are full?
- ☐ Did you insert the batteries by paying attention to their polarities?
- ☐ Did you correctly connect Raspberry Pico to the main board?
- ☐ Did you connect the servo motors to the pin specified in the code?
- ☐ Make sure that moving parts are correctly attached to the servo motors use the servo horn mounting screw while attaching the that has servo horns on them.

14

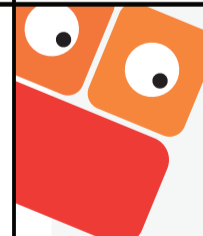

By scanning the QR code, you can access sample code for the project, STEM activity examples, and educational content. The Smart Home Pro Kit Book includes the Picobricks IDE, MicroBlocks, Thonny and Arduino code. Necessary for the project as well as computing and unplugged STEM activities for educators.

rbt.is/smarthomeproeducation



15